

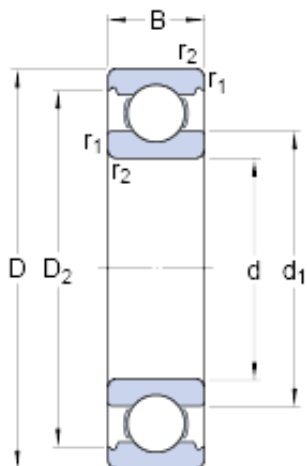

BEARING ITALIA S.P.A



75 mm x 95 mm x 10 mm skf W 61815 Deep groove ball bearings

Bearing No. W 61815

W 61815 Bearing 2D drawings and 3D CAD models

Size	95x75x10 mm
Bore Diameter	95 mm
Outer Diameter	75 mm
Width	10 mm
d	75 mm
D	95 mm
B	10 mm
d ₁	81.4 mm
D ₂	90.62 mm
r _{1,2} - min.	0.6 mm
D _a - max.	mm
r _a - max.	0.6 mm
Basic dynamic load rating - C	10.8 kN
Basic static load rating - C ₀	13.7 kN
Fatigue load limit - P _u	0.585 kN
Reference speed	14000 r/min
Limiting speed	8500 r/min
Calculation factor - k _r	0.02
d ₁	81.4 mm
D ₂	90.62 mm
r _{1,2} min.	0.6 mm
D _a max.	0 mm
r _a max.	0.6 mm
Basic dynamic load rating C	10.8 kN



BEARING ITALIA S.P.A

Basic static load rating C_0	13.7 kN
Fatigue load limit P_u	0.585 kN
Calculation factor k_r	0.02
Calculation factor f_0	17.3