

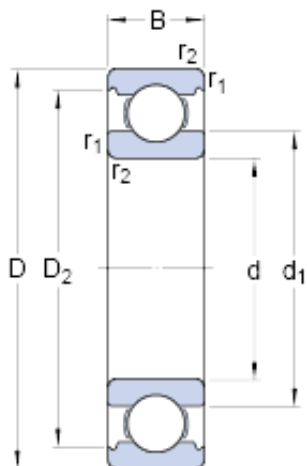

BEARING ITALIA S.P.A



50 mm x 65 mm x 7 mm skf W 61810 Deep groove ball bearings

Bearing No. W 61810

W 61810 Bearing 2D drawings and 3D CAD models

| | |
|---|-------------|
| Size | 65x50x7 mm |
| Bore Diameter | 65 mm |
| Outer Diameter | 50 mm |
| Width | 7 mm |
| d | 50 mm |
| D | 65 mm |
| B | 7 mm |
| d ₁ | 54.67 mm |
| D ₂ | 61.55 mm |
| r _{1,2} - min. | 0.3 mm |
| d _a - min. | 52 mm |
| D _a - max. | 63 mm |
| r _a - max. | 0.3 mm |
| Basic dynamic load rating - C | 5.1 kN |
| Basic static load rating - C ₀ | 5.5 kN |
| Fatigue load limit - P _u | 0.236 kN |
| Reference speed | 20000 r/min |
| Limiting speed | 13000 r/min |
| Calculation factor - k _r | 0.02 |
| Calculation factor - f ₀ | 15.3 |
| d ₁ | 54.67 mm |
| D ₂ | 61.55 mm |
| r _{1,2} min. | 0.3 mm |
| d _a min. | 52 mm |



BEARING ITALIA S.P.A

| | |
|--------------------------------|----------|
| D_a max. | 63 mm |
| r_a max. | 0.3 mm |
| Basic dynamic load rating C | 5.07 kN |
| Basic static load rating C_0 | 5.5 kN |
| Fatigue load limit P_u | 0.236 kN |
| Calculation factor k_r | 0.02 |
| Calculation factor f_0 | 15.3 |
| Mass bearing | 0.047 kg |