

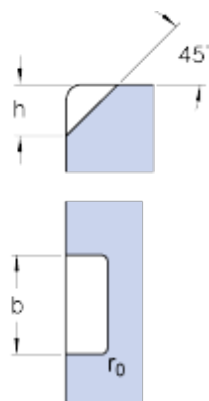

BEARING ITALIA S.P.A

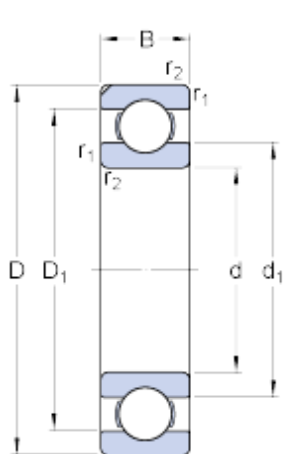

850 mm x 1220 mm x 165 mm skf 306493 AA
Deep groove ball bearings

Bearing No. 306493 AA

306493 AA Bearing 2D drawings and 3D CAD models

Size	1220x850x165 mm
Bore Diameter	1220 mm
Outer Diameter	850 mm
Width	165 mm
d	850 mm
D	1220 mm
B	165 mm
d ₁	973 mm
D ₁	1090 mm
h	32 mm
b	20.5 mm
r _{1,2} - min.	7.5 mm
r ₀	3 mm
d _a - min.	878 mm
D _a - max.	1192 mm
r _a - max.	6 mm
Basic dynamic load rating - C	1040 kN
Basic static load rating - C ₀	2700 kN
Fatigue load limit - P _u	35.5 kN
Reference speed	800 r/min
Limiting speed	670 r/min
Calculation factor - k _r	0.025
Calculation factor - f ₀	17
d ₁	973.2 mm



BEARING ITALIA S.P.A

D_1	1092.2 mm
r_0	3 mm
$r_{1,2}$ min.	7.5 mm
d_a min.	878 mm
D_a max.	1192 mm
r_a max.	6 mm
Basic dynamic load rating C	1040 kN
Basic static load rating C_0	2700 kN
Fatigue load limit P_u	35.5 kN
Calculation factor k_r	0.025
Calculation factor f_0	16.6
Mass bearing	630 kg