

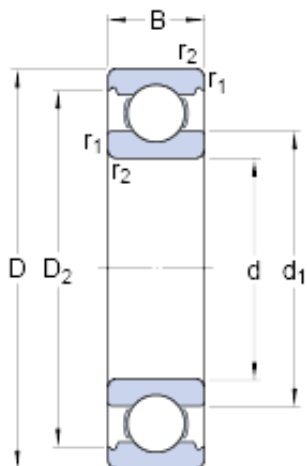

BEARING ITALIA S.P.A



30 mm x 72 mm x 19 mm skf W 6306 Deep groove ball bearings

Bearing No. W 6306

W 6306 Bearing 2D drawings and 3D CAD models

| | |
|---|--------------------------|
| Size | 72x30x19 mm |
| Bore Diameter | 72 mm |
| Outer Diameter | 30 mm |
| Width | 19 mm |
| d | 30 mm |
| D | 72 mm |
| B | 19 mm |
| d ₁ | 44.9 mm |
| D ₂ | 62.35 mm |
| r _{1,2} - min. | 1.1 mm |
| d _a - min. | 36.5 mm |
| D _a - max. | 65.5 mm |
| r _a - max. | 1 mm |
| Basic dynamic load rating - C | 22.9 kN |
| Basic static load rating - C ₀ | 15 kN |
| Fatigue load limit - P _u | 0.64 kN |
| Reference speed | 22000 r/min |
| Limiting speed | 14000 r/min |
| Calculation factor - k _r | 0.035 |
| Calculation factor - f ₀ | 13.3 |
| Category | Single Row Ball Bearings |
| Inventory | 0.0 |
| Manufacturer Name | SKF |
| Minimum Buy Quantity | N/A |



BEARING ITALIA S.P.A

| | |
|---------------------------------|--|
| Weight / Kilogram | 0 |
| Product Group | B00308 |
| Enclosure | Open |
| Precision Class | ABEC 1 ISO P0 |
| Maximum Capacity / Filling Slot | No |
| Rolling Element | Ball Bearing |
| Snap Ring | No |
| Internal Special Features | No |
| Cage Material | Stainless Steel |
| Internal Clearance | C0-Medium |
| Inch - Metric | Metric |
| Long Description | 30MM Bore; 72MM Outside Diameter; 19MM Outer Race Width; Open; Ball Bearing; ABEC 1 ISO P0; No Filling Slot; No Snap Ring; No Internal Special Features; C0-Medium Internal Clearance; Stainless Steel |
| Other Features | Deep Groove |
| Category | Single Row Ball Bearing |
| UNSPSC | 31171504 |
| Harmonized Tariff Code | 8482.10.50.68 |
| Noun | Bearing |
| Keyword String | Ball |
| Manufacturer URL | http://www.skf.com |
| Weight / LBS | 0.7496 |
| Bore | 1.181 Inch 30 Millimeter |
| Outer Race Width | 0.748 Inch 19 Millimeter |
| Outside Diameter | 2.835 Inch 72 Millimeter |
| Inner Race Width | 0 Inch 0 Millimeter |
| d ₁ | 44.9 mm |
| D ₂ | 62.35 mm |



BEARING ITALIA S.P.A

| | |
|--------------------------------|---------|
| $r_{1,2}$ min. | 1.1 mm |
| d_a min. | 36.5 mm |
| D_a max. | 65.5 mm |
| r_a max. | 1 mm |
| Basic dynamic load rating C | 22.9 kN |
| Basic static load rating C_0 | 15 kN |
| Fatigue load limit P_u | 0.64 kN |
| Calculation factor k_r | 0.035 |
| Calculation factor f_0 | 13.3 |
| Mass bearing | 0.33 kg |